

# MANCHESTER SCHOOL OF ARCHITECTURE

## Ponky's Park



Visit [msa.ac.uk](https://msa.ac.uk) for more information



# MSA LIVE 23

## Team

**Rebecca Clarkson** (MArch1)

**Ali Al-Siwife** (MArch1)

**Mastura Ramlan** (MArch1)

**Alisa Akmar Fadzil** (MArch1)

**Wenkai Zhang** (MArch1)

**Samuel Diamond** (MA)

**Daisy Nicholson** (BA1)

**Chi Fun Kwan** (BA1)

**Christian Brooker** (BA1)

**Ananya Tuteja** (BA1)

**Lucy Thomas** (BA1)

**Alicia Elliott** (BA2)

**Christiana Ashaye** (BA2)

**Nahima Begum** (BA2)

**Jacob Weall** (BA2)

**Maria-Alexandra Cardan** (BA2)

## Partners

Our collaborator for this project is 'ForTyldesley', an initiative in Tyldesley, a town located 12 miles from Manchester in the Borough of Wigan.

ForTyldesley is a community-led scheme and High Street Heritage Action Zone. With funding from Historic England, the action zone, which focuses on Elliott Street, the single main route running through Tyldesley, aims to transform the town's Conservation Area through a number of transformational schemes, including the small green space known locally as Ponky's Park.

# Agenda

## Ponky's Park

This student-led team is working in collaboration with ForTyldesley to propose designs for the redevelopment of a small green space along Tyldesley's historic high street. The project has allowed students to prepare and undertake a public consultation with key stakeholders and community groups, in order to develop and test themes and inspire design ideas.

Students were able to collaboratively produce design proposals in response to the feedback collected from the community, creating illustrative visuals, drawings and models of the green space. Throughout this workshop, the team have developed their sketching and model making ability, in addition to gaining valuable skills in communication, public speaking, and organisation through stakeholder engagement activities.

The final design outcome proposed by the team, inspired by the feedback gained through the numerous stakeholder engagement activities, will be used by ForTyldesley as a starting point through the planning process, and ultimately shape the development of Ponky's Park.

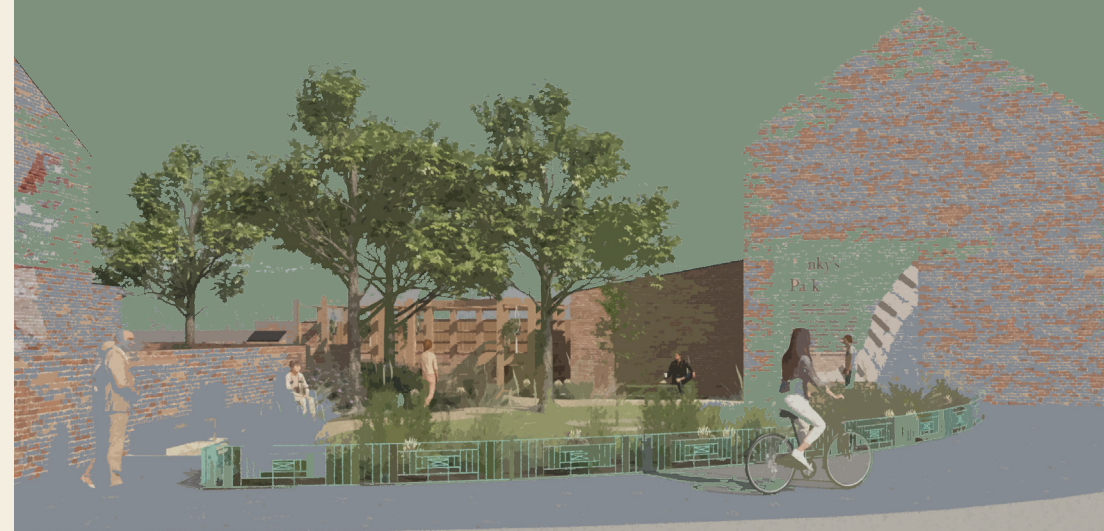



# Site Introduction

## Site - Ponky's Park

Tyldesley's heritage dates to Roman times with the current community being strongly influenced by the town's growth from the industrial revolution and regional mining history. Ponky's Park is a small pocket of green space located at the end of Tyldesley's main 'high street', enclosed with a locally admired Art Deco fence. The current condition is the result of low maintenance and investment, leaving the greenery to overgrow. The park sits in a conservation area, bordering a popular local pub and opposite the local Parish church, both widely used by community groups.

## Meeting With Collaborator

On the 1st of February the group went of a site visit to discuss initial ideas and considerations for the development of the site. The collaborator proposed **"memorial garden/reflection area with new seating and planting. Possibly to include a locally produced art/sculpture installation. We'd like to work with local groups and organisations, such as George's Church, Tyldesley Methodist Church, Local British Legion and Astley Mining Museum."** Now part of the 'ForTyldesley' four-year community-led scheme, locals are eager to transform the site into usable public area, retaining and adding as much greenery as possible.

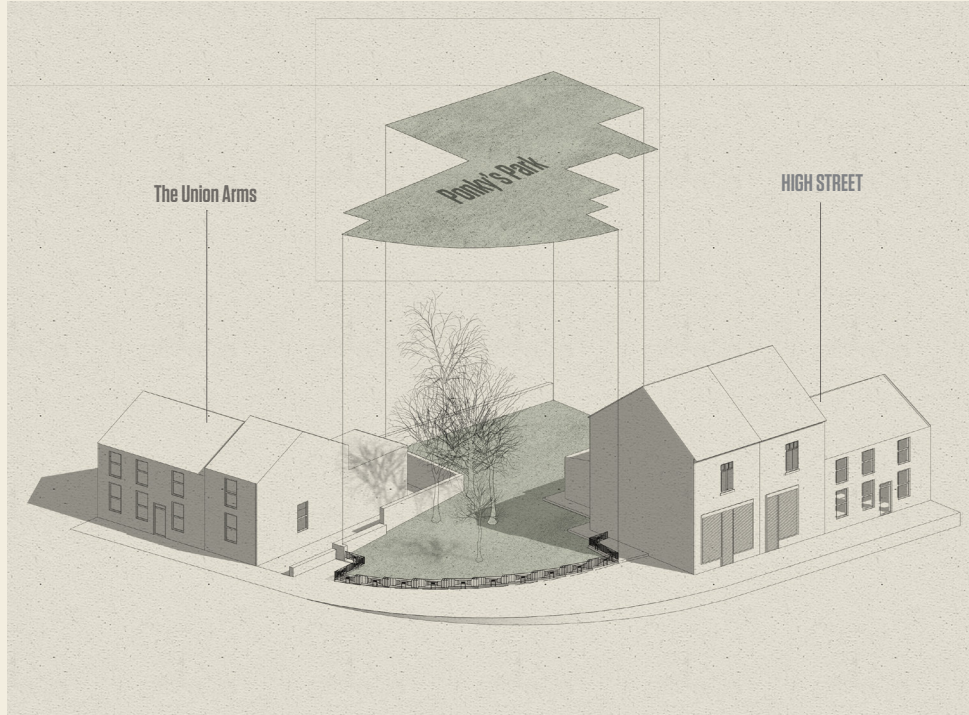

## Six Key Stages

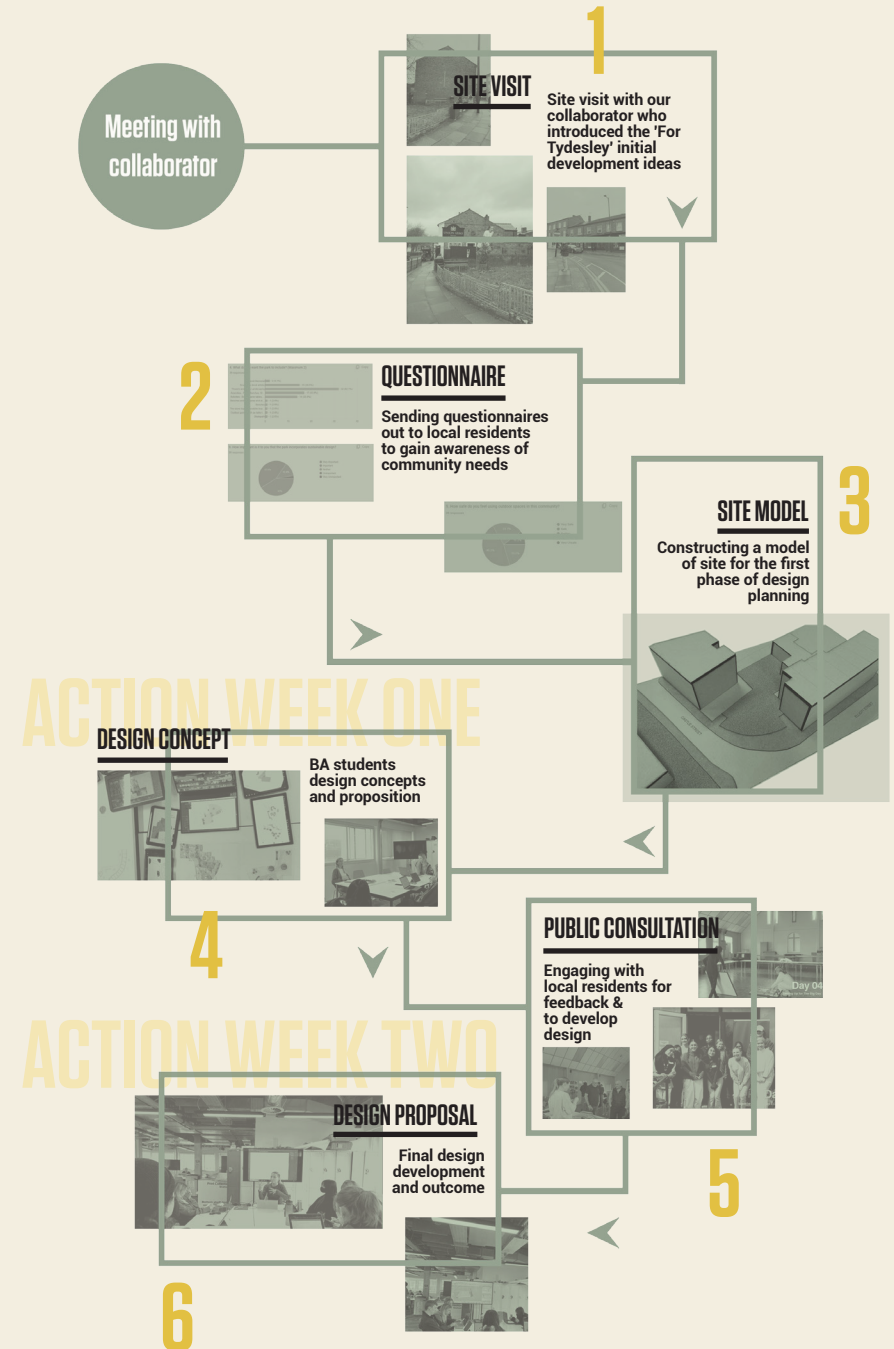



## Stakeholder Engagement

On Friday the 12th of May, a public consultation day was held by the team at Astley & Tyldesley Methodist Church, with an open invite to all Tyldesley residents. The space was set up for the planned activities, ready to welcome members of the local community.

The session allowed the team to participate in fruitful discussions and exchange ideas with stakeholders, local residents and the collaborators, encouraging their feedback (positive and negative!) in order to progress with our scheme. The collected feedback from both the public consultation day, and the previously circulated online questionnaire were then dissected and used by the students to progress the design.

Ultimately, through the involvement of the public in the initial stages of this design project, the team was able to understand the needs of the community, apprehend their vision, and incorporate and reflect their voices, concerns and aspirations into a final design proposal for the development of Ponky's Park.



## Local Knowledge and Expertise

The people of Tyldesley shared their views and contributed to finding effective solutions for Ponky's Park.

## Collaborations and Empowerment

The active participation from the local residents fosters a sense of unity and ownership of the space.

Image: A local couple partaking in the drawing activity to share their vision of Ponky's Park.



# What do Tyldesley Want?



**IAN TOMLINSON**  
COLLABORATOR

## Involve the local school students

Well-lit  
park for safety

**Rebuild using the same bricks!**

## A calm space

**Have a covered area for shelter**

Include disabled access

Keep the railings  
& trees!

## Vandalism-proof

Encourage  
areas for wildlife

### Provide benches

Include a memorial sculpture

**Colourful all-year flowers!**

Advertisement  
area?

## Litter-free space

**Safer environment  
for the community**

The locals were given Post-it notes to voice their opinions on the existing site. Numerous responses were received, demonstrating how valued the space is within the local community.



This wordcloud is formed from key words raised by the public during the engagement activities, when describing their perfect Ponky's Park. The majority of the local residents prefer an accessible, safe & well-lit park.

## Ponky's Park Questionnaire

**72.0%**

of the respondents are 41 years and above

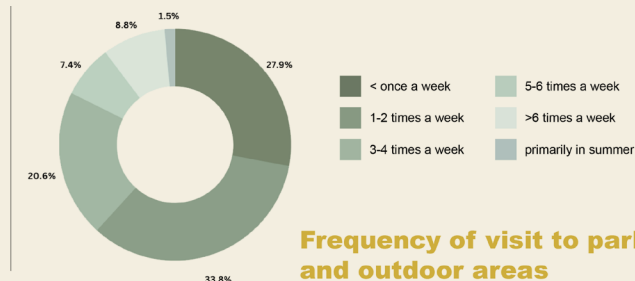

### Frequency of visit to parks and outdoor areas



**62** out of 68 reponses voted for **walking**



**15** out of 68 reponses voted for **picnicking**



**11** out of 68 reponses voted for **biking**

**"Trees are essential and precious. Sculpture especially by local artists would be great if it is resilient enough for our persistent vandals!"**

**"The area needs something beautiful to look at. Tyldesley still looks neglected so something to improve the aesthetics is needed"**

**"A flower garden would be fabulous to cheer up a neglected area of the town. Some benches to enjoy it would be good."**



# Design Development

Throughout the action weeks the team produced designs for the green space including sketch plans, visuals and pergola proposals. A prototype model of the final pergola design was produced, in addition to a base site model in order to test the designs within their context.

## Pergola Design Development

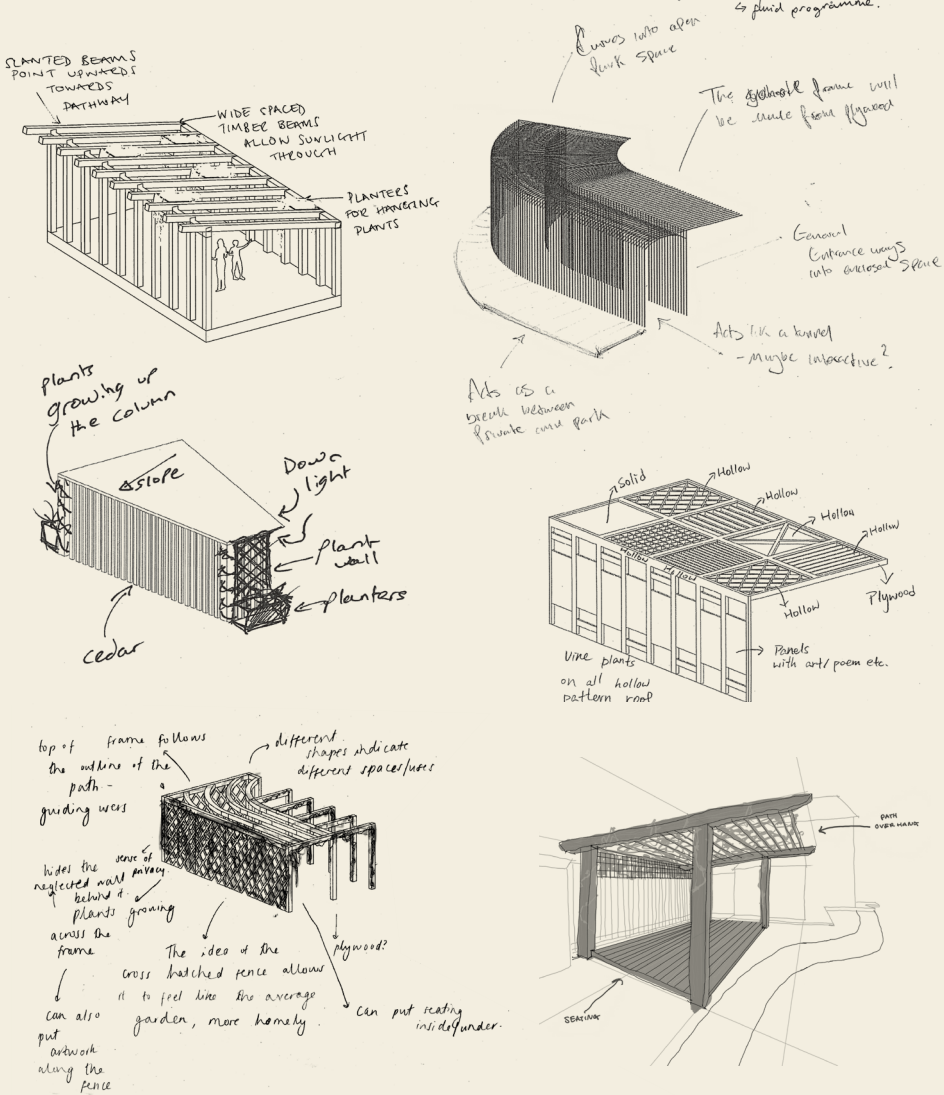

## Pergola Prototype Model



## Initial Sketch Concept Plans



Sketch Visualisation



Site Model used for Design Exploration





Model Displaying the Final Design Proposal



## The Proposal: Visualisations

The adjacent visualisations illustrate the proposed scheme at Ponky's Park. The design aimed to respond to the valuable feedback received by the team from residents of Tyldesley through the stakeholder engagement activities, incorporating their ideas, visions and criticisms of the current site. The beloved Art Deco railings have been retained in addition to the multiple protected trees and new accessible routes are proposed opening up the currently neglected space. The scheme endeavours to inject greenery and colour into the small corner of the highstreet, providing seating, litter bins, lighting and artwork to ultimately create a calm, clean and welcoming environment.





## ABOUT

Each year the MSA LIVE programme unites Masters Architecture year 1 students with those in BA year 1 and year 2 and Masters Landscape Architecture 1 in mixed-year teams to undertake live projects with external partners to create social impact.

## LIVE PROJECTS

All MSA LIVE projects are live. A live project is where an educational organisation and an external partner develop a brief, timescale, and outcome for their mutual benefit.

## SOCIAL IMPACT

All MSA LIVE projects have social impact. Social impact is the effect an organization's actions have on the well-being of a community. Our agendas are set by our external collaborators.

## EXTERNAL PARTNERS

MSA LIVE projects work with many organisations: charities, community groups, social enterprises, community interest companies, researchers, practitioners and educators.

## STUDENT-LED

Our MSA masters students take the lead in the project conception, brief development, delivery and co-ordination of a small project. Other cohorts joined for an eventful 2 weeks of activities at the end of the academic year.

## KNOWLEDGE TRANSFER

Working in teams within and across year groups and courses; MSA students participate in peer to peer learning. In addition, collaborators, participants and students engage in the transfer of tangible and intellectual property, expertise, learning and skills.

## LARGE SCALE

This year approximately 650 students from 4 cohorts in MSA have worked on 42 projects with partners.

## QUESTIONS

For questions about MSA LIVE please contact the MSA LIVE team:

**[msalive@mmu.ac.uk](mailto:msalive@mmu.ac.uk)**

## BLOG

**[live.msa.ac.uk/2023](http://live.msa.ac.uk/2023)**

## SOCIAL

**#MSALive23**

**@msa.live.23**

**@TheMSArch**

**@MLA\_TheMSArch**

## WEBSITE

**[www.msa.ac.uk](http://www.msa.ac.uk)**